

NOTES:

Voltage Rating:100V,AC/DC
Current Rating:1.5 AMP,AC/DC
Dielectric Withstand Voltage:500V,AC/Minute
Contact Voltage:20 mΩ Max
Insulation Voltage:1000 mΩ Min
Operation Temperature:-40℃ to +105℃
Insulator Material:Polyester,UL94 V-0
Contact Material:Brass
Contact Plating:Au or Sn Plated on Nickel Overall

NEW PART NUMBER

FBPHC-150 PH B 20-11 XX M XX X XXX XX

Housing Height
20=2.00

NO.of Pins
Per Row
2-40P

Contact Plating
G0=Gold Flash
G1=3u"Gold
G2=5u"Gold
G3=10u"Gold
G4=15u"Gold
G5=30u"Gold
SN=Tin Plated

Pin Length
105=10.50

Packing
O=PE Bag
A=Tray
T=Tube

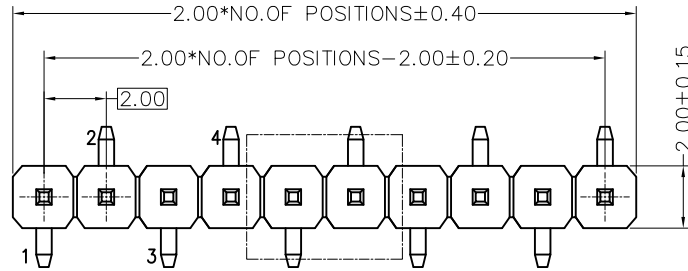

正脚位

TYPE 1: FBPHC-150PHB20-11XXMXXXXXXX1

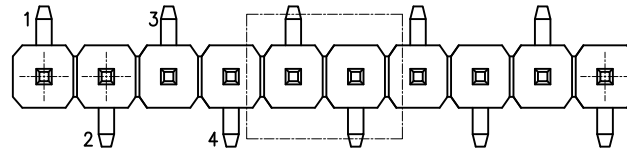

反脚位

TYPE 2: FBPHC-150PHB20-11XXMXXXXXXX2

Recommended P.C.B Layout
P.C.B Board Tolerance±0.05

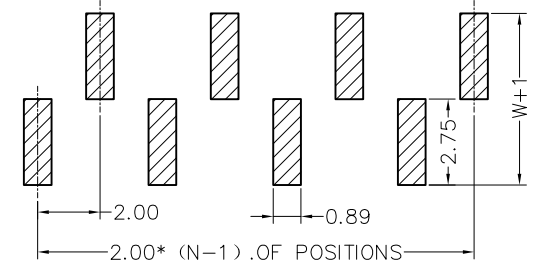

正脚位

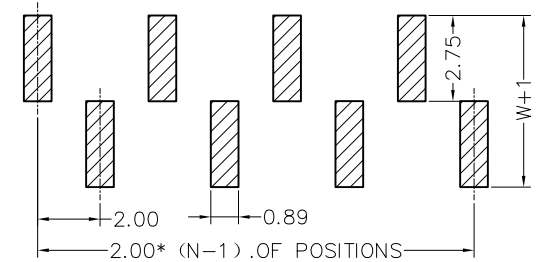

反脚位

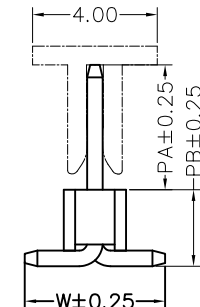
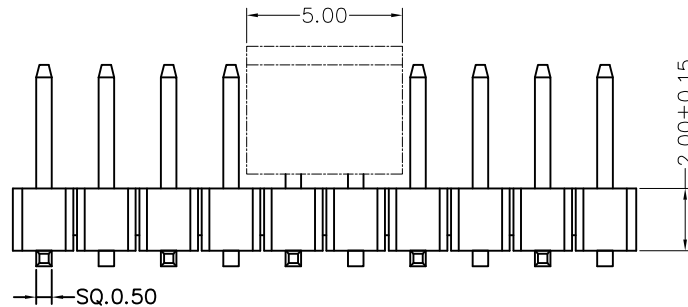

Dimension antitheses list

item	PA	PB	W	L
Standard	3.80	2.50	4.50	8.00
Alternate	---	---	---	---

				OPERATION		DRAW	Helen	2011/11/12	F B E L E			
				X.X	±0.40	DESIGN	Jenny	2011/11/12	PART NO.	FBPHC-150 PHB20-11XXMXXXXXXXXXX	UNI	mm
				X.XX	±0.25						SCALE	1:1
				X.XXX	±0.15						CHECK	Franck
A0	2011/11/12	NEW		Angle	±3°	APPROVE	Steven	2011/11/12				
REV	DATE	MODIFICATION DESCRIPTION	CHANGE	DIM	TOL				Customer NO.	---		